

517 Miniature Cartridge Fuse

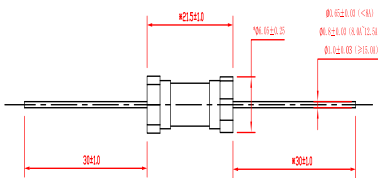

Dimensions (unit: mm)

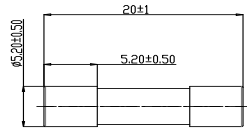

Main Characteristics

Miniature fuse; Very Fast-Acting

Standard

UL248-14 IEC60127-7

Materials

Tube: Ceramic Tube
End Caps: Nickel plated copper

Operating Temperature

-55°C to +125°C

Storage Conditions

+10°C to +60°C
Relative humidity: ≤75% yearly average
Without dew, maximum 30 days at 95%

Vibration Resistance

24 cycles at 15 min. each (60068-6)
10-60Hz at 0.75mm amplitude
60-2000Hz at 10g acceleration

Soldering Parameters

260°C. ≤5 sec (Wave Soldering)
350°C. ≤3 sec (Hand Soldering)
Soldering Peak:
260°C. 10 sec. (IEC 60068-20)

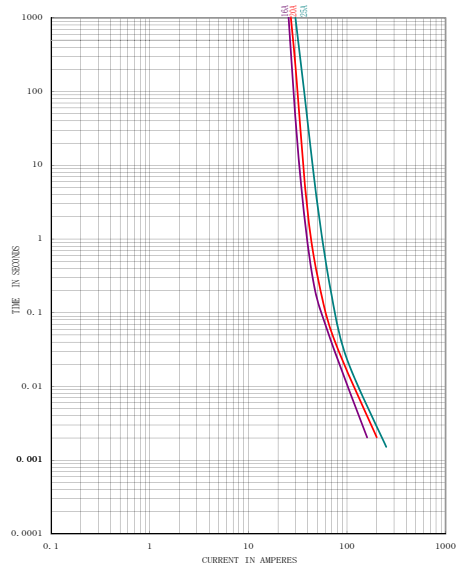

Time vs Current Characteristics: UL248-14

| Rated Current | 100% | 210% | 275% | 400% | 1000% |
|---------------|------|--------|----------|---------|-------|
| 16A~25A | >1h | <30min | 40ms~20s | 10ms~1s | ≤30ms |



Electrical Characteristics at 25°C

| Amp Code | Rated Current | Rated Voltage | Voltage drop Max.(mV) | Nominal Melting I²t (A²sec) | Typical cold Resistance (mΩ) | Breaking Capacity | Approvals | |
|----------|---------------|--------------------|-----------------------|-----------------------------|------------------------------|------------------------------|-----------|-----|
| | | | | | | | cURus | TUV |
| 2160 | 16A | 500V DC 600V AC | 250 | 52.0 | 5.91 | 100A@600V AC 400A@500V DC | • | • |
| 2200 | 20A | | 250 | 82.0 | 4.79 | | • | • |
| 2250 | 25A | | 250 | 95.0 | 3.36 | | • | • |

Notes: (1) Permissible continuous operating current is ≤100% at ambient temperature of 23°C (73.4°F)
(2) Typical pre-arcing I²t are measured at 10In current.

Ordering Information

| Series | Amp Code | Supplementary Code | Qty |
|--------|----------|--------------------|-----|
| 517 | | | |