

# HSF

**NOTES:**

Current Rating: 1.0AMP  
 Contact Resistance: 20mΩ Max  
 Withstand Voltage: 500V AC/DC  
 Insulation Resistance: 1000MΩ Min  
 Operation Temperature: -40℃ to +105℃

Contact Material: Phosphor Bronze  
 Contact plating: Sn Over Ni  
 Insulator Material: PA46+30%G.F UL94V-0

Recommended P.C.B Layout (Top Side)  
 (PCB BOARD TOLERANCE ±0.05)

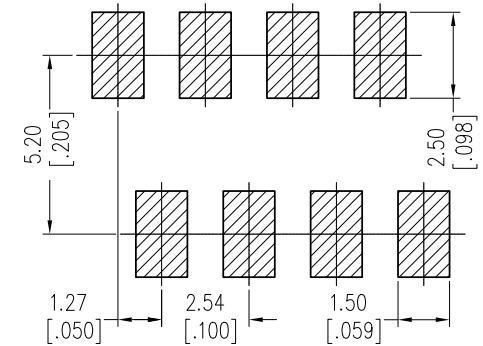
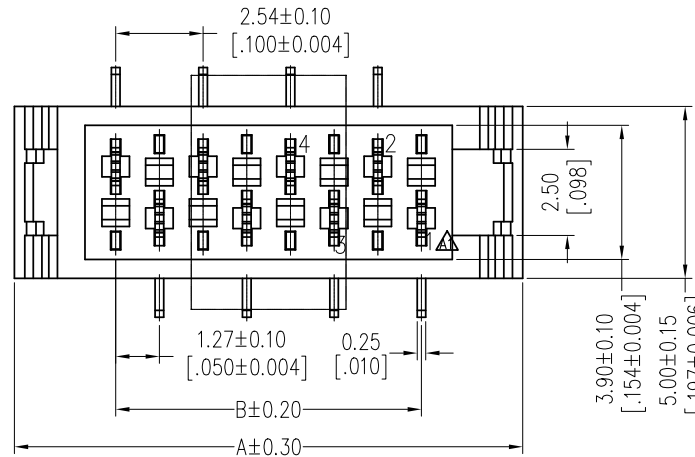

## Ordering Information

3900-XX FM SN E W T 01

No. of Pins	Contact Plating	Insulator Material	Packing
04P 12P	SN= Tin	E=PA46	T=Tube
06P 14P			P=Tube+CAP
08P 16P			R=Tape&Reel+CAP
10P 18P			
20P			

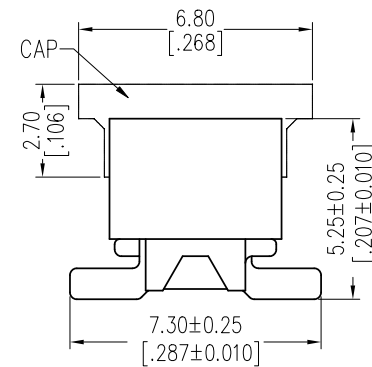
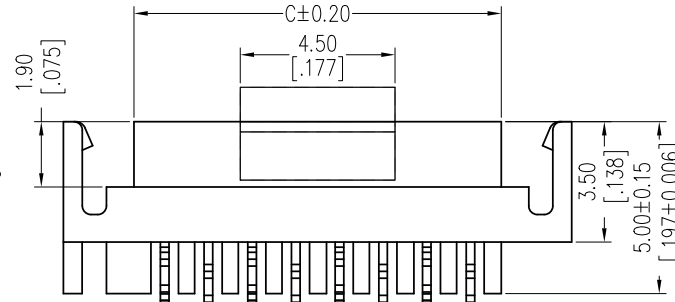

Specification & Ordering Information:

Circuit	Part No.	Dimension			Q'ty /Tube
		A	B	C	
04	3900-04FMSNEWX01	9.70	3.81	5.60	59
06	3900-06FMSNEWX01	12.24	6.35	8.14	47
08	3900-08FMSNEWX01	14.78	8.89	10.68	39
10	3900-10FMSNEWX01	17.32	11.43	13.22	33
12	3900-12FMSNEWX01	19.86	13.97	15.76	29
14	3900-14FMSNEWX01	22.40	16.51	18.30	25
16	3900-16FMSNEWX01	24.94	19.05	20.84	23
18	3900-18FMSNEWX01	27.48	21.59	23.38	21
20	3900-20FMSNEWX01	30.02	24.13	25.92	19

REV	DATE	MODIFICATION DESCRIPTION	CHANGE	DIM	TOL	OPERATION	DRAW	DATE	SCALE	FIT	PART NO.
A3	2018/05/15	MINI MATCH--1.27mm MRC Connector	----			OPERATION	Ding	2018/05/15	UNIT	mm	SEE TAB
A2	2014/05/28	Micro Match --Mini Match	----	x.x	±0.40				SIZE	A4	TITLE: 1.27mm MRC Connector Socket 180° SMT With Latch
A1	2014/04/02	MODIFY	----	x.xx	±0.25	CHECK			SHEET	1/1	
A0	2012/10/11	NEW	----	x.xxx	±0.15	APPROVE			PROJ.		
				Angle	± 3'						Customer NO.